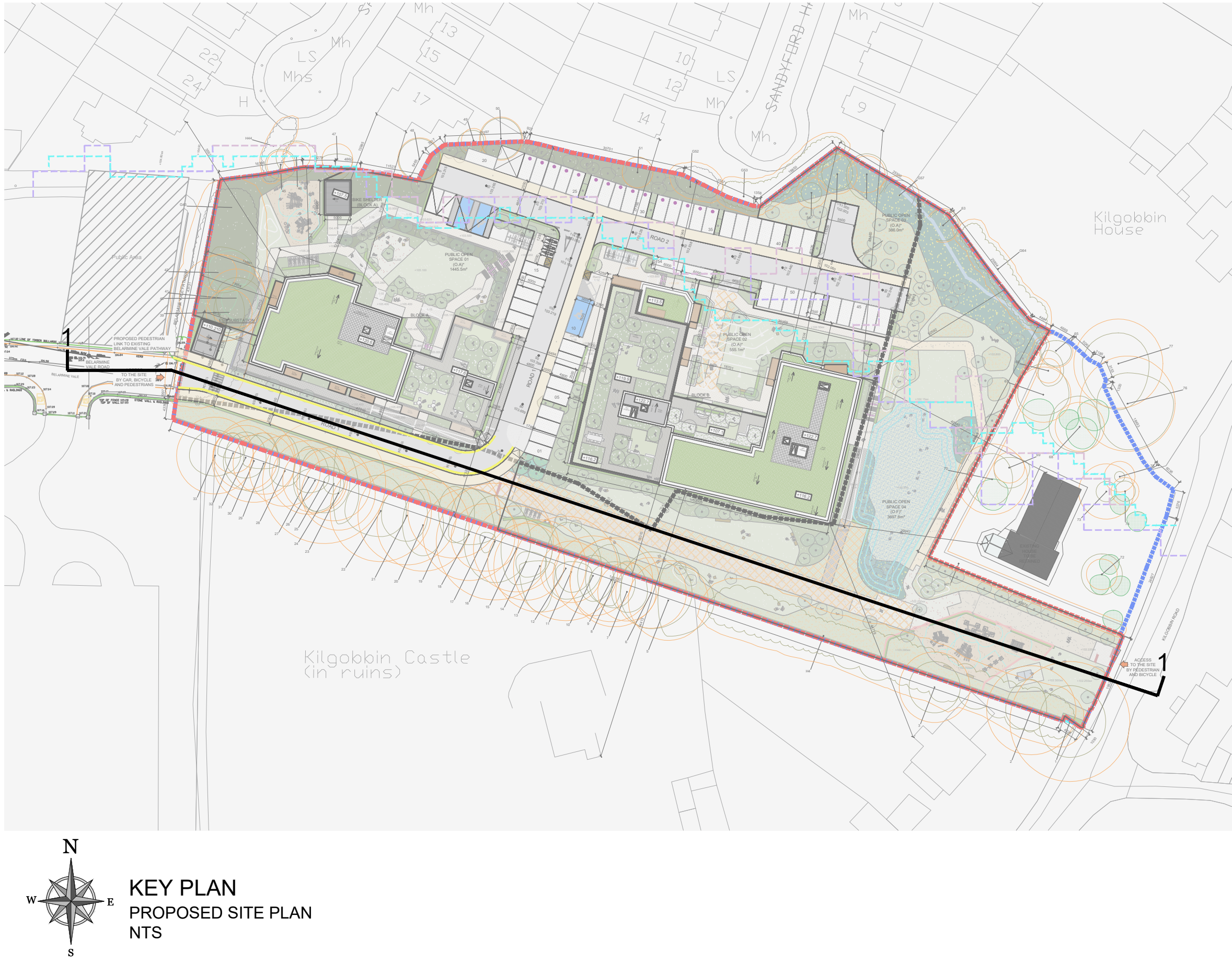

Architectural elevation drawing of the proposed development at 1531 Kilgobrin Road. The drawing shows two main building blocks, Block A and Block B, with their respective heights and setbacks. Block A is 17.25m high and Block B is 16.70m high. The drawing also shows the existing dwelling, the proposed kids play area, and the surrounding landscape with trees and a public area. The drawing is labeled "SUBJECT TO THIS APPLICATION" and "PROPOSED BLOCK A - SOUTHWEST ELEVATION" and "PROPOSED BLOCK B - SOUTHWEST ELEVATION".

KEY PLAN
EXISTING SITE PLAN
NTS

[illegible]